

VOLVO HIGHLIGHTS



Fuel Pump

03.14.006

Ref-No.: 21067551



Engine:
D12A, D12C, D12D, DH12D,
DH12E, TD122, TD123

Type:
8500, 8700, 9700, 9900, B 12,
FH 12, FL 12, FM 12, NH 12

Details:
Operation mode: mechanical

01.14.010 Spring

03.38.008 Gasket, fuel pump

Air Filter

03.14.031

Ref-No.: 20411816



Engine:
D16C, D16E, D16G, D16K

Type:
FH 16, FH 16 II

Details:
Height: 469 mm;
Inner Ø: 195 mm;
Outer Ø: 212 mm

Charger, charging system

03.14.051

Ref-No.: 8113407



Engine:
D9A, D12A, D12C, D12D, D16C,
D16E, D16G, TD122 - TD123

Type:
B 12, FH 12, FH 16, FL 12, FM 9,
FM 12, NH 12

01.16.001 Gasket, charger

NOx Sensor, urea injection

03.17.039

Ref-No.: 22219283



Engine:
D5K, D8K, D11A, D11B, D11C,
D11K, D13A, D13B, D13C, D13H,
D13K, D16A, D16B, D16C, D16E,
D16G, D16K

Type:
7900, 8900, 9500, 9700, 9900,
B 11, FH, FH 16, FH 16 II, FH II,
FL III, FM, FMX, FMX II

Coolant Tube

03.19.123

Ref-No.: 20555313



Engine:
D9A, D9B, D11C, D11K

Type:
FM 9, B 11

Details:
With seal

Repair Kit, clutch booster

03.23.016

Ref-No.: 3093098



Type:
8500, 9700, 9900, B 12, FH,
FH 12, FH 16, FH 16 II, FH II,
FM, FM 7, FM 9, FM 10,
FM 12, FMX, FMX II

03.23.123 Clutch Booster

03.23.001 Clutch Booster

Repair Kit, clutch master cylinder

03.23.033

Ref-No.: 3094730



Type:
B 12, F 10, F 12, F 16, FH 12,
FH 16, FL 7, FL 10, FL 12, FM 7,
FM 10, FM 12, N 10, NH 12

Details:
Ø of piston: 28,5 mm

03.23.002 Master Cylinder,
clutch

Solenoid Valve, shift cylinder

03.23.173

Ref-No.: 22327063



Type:
8500, 8700, 9700, 9900, B 9,
B 12, FH, FH 16, FH 16 II,
FH II, FM, FMX

Details:
Cable length: 310 mm

03.23.160 Central Slave
Cylinder, clutch



VOLVO HIGHLIGHTS



Shift Selector Lever

03.24.028

Ref-No.: 21073025



Type:
B 9, B 11, B 12, FH 12, FH 16,
FH 16 II, FH II, FM 7, FM 9,
FM 10, FM 12

Details:
Only for Left-Hand-Drive

Multiport Valve

03.25.004

Ref-No.: 1669419



Type:
F 10, F 12, F 16, FH 16, FL 7,
FL 10, N 10

Details:
Max pressure: 10 bar;
Thread size: M10 x 1

Rod Assembly

03.31.041

Ref-No.: 20587731



Type:
FH, FH 12, FH 16, FH 16 II, FH II,
FM, FM 12, FMX, FMX II

Details:
Length: 1660 mm; Cone: 32 mm

Hydraulic Pump, steering system

03.37.065

Ref-No.: 20902700

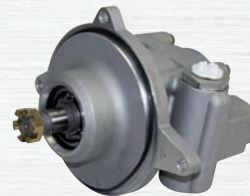

Type:
FH, FH 16, FM, FM 9

Details:
Operating pressure: 200 bar

Sensor, pneumatic suspension level

03.42.026

Ref-No.: 20850557



Type:
7700, 8500, 8700, 9700, 9900,
B 6, B 9, B 10, B 12, FE II, FH,
FH 12, FH 16, FH 16 II, FH II, FL,
FL 6, FL II, FM 9, FM 10, FM 12,
FMX, FMX II

Details:
Operating voltage: 24V

Starter

03.42.062

Ref-No.: 20732404



Engine:
D16C, D16E, D16G

Type:
FH 16, FH 16 II

Details:
Operating voltage: 24V;
Power 7kW

Switch, headlight

03.42.066

Ref-No.: 20953569



Type:
B 6, B 7, B 9, B 12, FH 12, FH 16,
FM 9, FM 12, FMX, FMX II,
NH 12

Details:
Number of pins: 13

Control, seat adjustment

03.64.001

Ref-No.: 20443641



Type:
FM 9, FM 12, FMX II, FH 12,
FH 16

Details:
Operation mode: pressure
controlled

All stated genuine numbers serve only for comparison purpose and may not be used as original reference.

2020: 00.98.125



www.trucktec.de